

PERFORMANCE

Model	Maximum flow rate			Maximum head	
	l/min	cu.m/hr	gall/min	metres	feet
PC50B18	383	23	84	29	95

Maximum power absorbed 3kW at 1500rpm

DIMENSIONS IN MM (APPROX.)

WEIGHT: 29.5kg

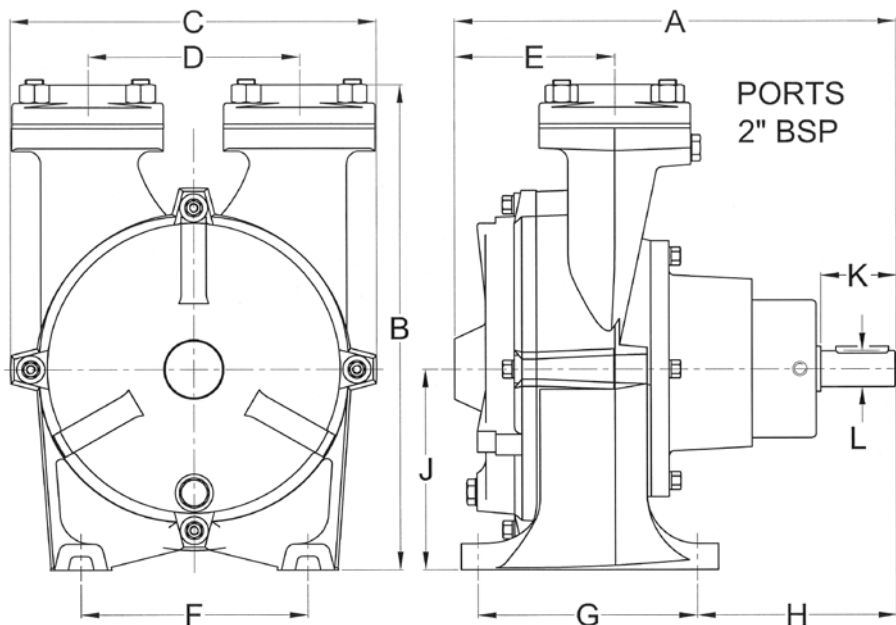

A	B	C	D	E	F	G	H	J	K	L
292	323	242	140	106	150	145	132	134	50	Ø24

MATERIALS OF CONSTRUCTION

Pump casing	bronze
Impeller	bronze
Port counterflanges	bronze
Shaft	stainless steel AISI316
Bearing housing	cast iron
Pump head bolts	stainless steel
O-ring static seal	nitrile rubber

Pump performance and specification are subject to alteration without notice

AVAILABLE CLUTCHES *(ask for a data sheet)*

Clutch Type	Pulley Pitch Dia	Pulley Belt Section	No of Belts	FP Code
MANUAL	140mm	B	2	FP-94-8090611
MANUAL	160mm	SPB	2	FP-94-8080611
24v dc	180mm	SPB	2	FP-94-8000527

FP PUMPS

PC50B18

2" BRONZE SELF-PRIMING SIDE CHANNEL PUMP

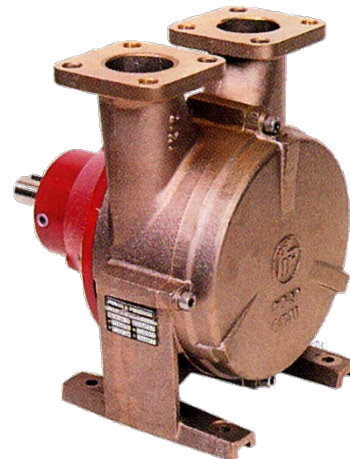

- ◆ reliable continuous duty pump
- ◆ corrosion-resistant bronze, with stainless steel shaft
- ◆ self-priming up to 4m
- ◆ bi-directional, flow can be reversed
- ◆ carbon-ceramic mechanical shaft seal

BRONZE PUMPS

for

SEAWATER

Xylem Water Solutions UK Ltd
Bingley Road
Hoddesdon
Hertfordshire • EN11 0BU • UK

Tel: +44 (0)1462 480380
Fax: +44 (0)1462 482422
mail@cleghorn.co.uk
www.jabscoshop.com

xylem
Let's Solve Water